



Product Name

ISOVER Spacesaver Roll

A mineral wool roll for domestic attic floors.
Rolls pre-perforated to 3 x 386cm and 2 x 580cm widths to fit between common joist spacings.

ISOVER G3 Touch – all our mineral wool products are manufactured using G3 Touch technology. High performance mineral wool insulation, naturally strong & gentle - made from recycled materials.





ISOVER Spacesaver Roll



W/mK 0.044

BENEFITS AND FEATURES

THERMAL	Conductivity 0.044 W/mK.
ACOUSTIC	Excellent Acoustic Performance.
FIRE	Excellent Fire Safety - A1 Fire Rated, highest possible rating. Completely fire safe - Euroclass A1 fire rating when classified in accordance with BS EN 13501-1.
STRENGTH	Excellent Recovery and strength.
EASY TO INSTALL	Friction fits between timber joists. Easy to install.
BREATHABILITY	The breathability of Metac compliments the dynamic characteristics of the Vario™ intelligent membrane range. When installed with Vario XtraSafe, Metac can be fully filled between rafters below both breathable and non-breathable roofing systems.*
ENVIRONMENTAL CREDENTIALS	Made from recycled glass. Minimal manufacturing and on-site wastage. Low carbon footprint at manufacture and during transport.

STANDARDS & CERTIFICATION

QUALITY	We hold a Quality Management Standard BS EN ISO 9001: 2008 for manufacturing.
CE	All products are manufactured in accordance with the CE marking requirements under the Construction Products Regulation,
PRODUCT STANDARDS	All our products are manufactured in accordance with product standard: BS EN 13162: 2008 and BS EN 13172 Evaluation of Conformity.
ENVIRONMENT	ISOVER is an ISO 14001:2004 (Environmental Management System) accredited manufacturing facility. This accreditation ensures that all products are manufactured to the stringent standards set out by this management system. EN ISO 13162 EMS 551706 003 BS EN ISO 9001: 2000
INDOOR AIR QUALITY	Awarded the highest standard in indoor air quality - Eurofins "Gold" Label The Gold Certificate means that ISOVER mineral wool is certified as an outstanding material in terms of Indoor Air Quality emissions regulations.
DURABILITY	Fire Performance Euroclass classification of the product is related to the organic content, which cannot increase with time. Thermal conductivity of mineral wool products does not change with time, experience has shown the fibre structure to be stable and the porosity contains no other gases than atmospheric air. (See std EN13162:2012 Annex ZA, Table ZA.1) Will not accelerate corrosion with steel, copper or aluminium. Will not sustain vermin, nor breed or promote fungi or bacteria.



Variants

	Thickness (mm)	Width (mm)	Length (mm)	Pack area (m ²)	Pack per pallet
Spacesaver G3 Touch	100	1160	9170	10.64	24
Spacesaver G3 Touch	150	1160	6030	6.99	24
Spacesaver G3 Touch	170	1160	5390	6.25	24
Spacesaver G3 Touch	200	1160	3880	4.50	24

For more applications and product details, please visit www.isover.ie



ISOVER Spacesaver Roll Application

Attic Floors Insulation between and over joists

INSULATION 1ST LAYER	Insulation 2nd Layer	Airtightness and Moisture Control	Board Lining	U-Value W/m ² K
100mm Spacesaver	140mm Heatshield	Vario membrane + tapes	12.5mm Gyproc WallBoard	0.16
150mm Spacesaver	150mm Spacesaver	Vario membrane + tapes	12.5mm Gyproc WallBoard	0.15
150mm Spacesaver	200mm Spacesaver	Vario membrane + tapes	12.5mm Gyproc WallBoard	0.13
200mm Spacesaver	200mm Spacesaver	Vario membrane + tapes	12.5mm Gyproc WallBoard	0.11

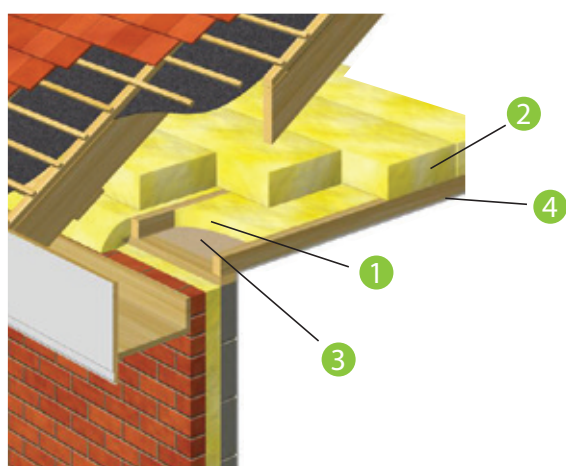

Attics

Insulation between and over joists

- 1 ISOVER insulation between joists
- 2 Second layer of ISOVER insulation cross laid over joists
- 3 Vario membrane + tapes
- 4 Gyproc WallBoard

Basic Installation Steps



1. Measure depth and width of your joists. Typically joists are 100mm deep and 600mm wide.
Simply measure the width and depth of your house and log onto www.isover.ie to use our handy insulation calculator.



5. Once the first layer is completed, you should put on the tank cover and make it secure with tape.
Then, put on the pipe covers and seal with a tape - such as our Vario Multi-tape SL.



2. Treat sockets and downlighters with a socket box and remember to leave a 75mm gap around the cable, where these cables can't be lifted above the insulation.

Don't put insulation under the water tank! This is best-practice to avoid water tank freezing in low temperatures.

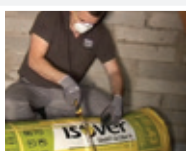

3. For the first layer of insulation, lift your insulation through the attic hatch - whilst keeping the packaging on.
Then cut the insulation to match the width of your joists. Finally for this step: Starting at the end furthest away from the attic door, simply roll and friction fit between the joists.

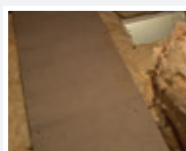

6. Put a walkway to your tank. You can do this by:
 - ✓ Securing timber across the joists
 - ✓ Laying the top of layer of insulation between them
 - ✓ Then laying a walkable wood board on top

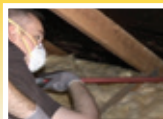

- Use the handle of a brush or something similar to push the insulation into "hard to reach" places - but take care not to compress the insulation.

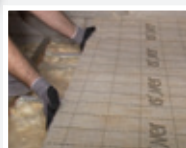

7. When your 1st layer is complete you are ready for the top up layer.
Open Heatshield roll and roll out in the opposite direction across the joists. Ensure you join each layer and leave no gaps.



4. It's important to ensure your attic space is well-ventilated to prevent a build up of moisture and condensation.
For this purpose, we recommend that you leave a gap of 50mm between the roofing membrane and the insulation at eaves of the roof.



8. Insulate your attic hatch by making a bag filled with insulation, preferably using vapour membrane. You can use Isover Vario membrane filled with leftover insulation. Place it over the attic hatch. For extra protection - use a draft seal tape around the door surround to create an airtight seal.
Exit carefully and adjust the bag in the right place. Close the hatch.

ISOVER Ireland
Unit 4, Kilcarbery Business Park,
Nangor Rd., Dublin 22
Tel: +353 (0) 1 629 8400
Email: info@isover.ie
Web: www.isover.ie

ISOVER Technical Team
ROI Free Phone: 1800 744 480
NI Phone: 0845 399 0159
Email: tech.ie@saint-gobain.com